

PRELIMINARY CONCEPTUAL PLAN BARE LAND CONDOS

FOR
K W POND LIMITED
ON LANDS DESCRIBED AS
PID 40091720 & PID 40498958 (LOT 07-1)
LAND TITLES FIRST NOTICE 17817579
N.C.R.O. PLAN NO. 27123802

PORTER COVE ROAD
PARISH OF NORTHUMBRIA
COUNTY OF NORTH BRUNSWICK
PROVINCE OF NEW BRUNSWICK
TRAINOR SURVEYS (1974) LTD.
WWW.TRAINORSURVEYS.COM
60 BISHOP DRIVE, SUITE 2 (506) 488-9494 TEL. N.
FREDERICTON, N.B. (506) 450-6081 FAX N.
E.C. 1B2

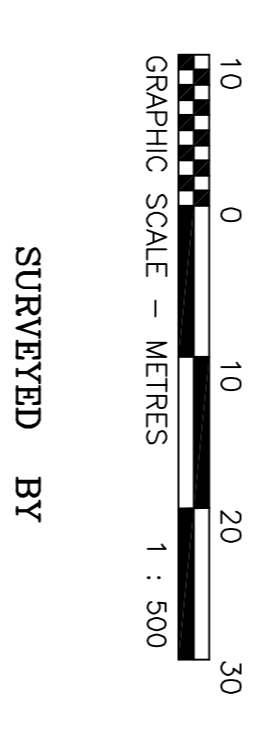

SURVEYED BY
DOUGLAS E. MORGAN, N.E.L.S. (ANBLS N.272)
DATE: MAY 11, 2010
DATE OF SURVEY: MARCH 2, 2010
REFERENCE N. 10051DWG

NOTES

1. ALL DIMENSIONS ARE IN METRES AND DECIMALS THEREOF.
 2. THE PLAN HEREON HAS BEEN ARRANGED AT AND/OR COMPILED FROM CONSIDERATION OF SOME OR ALL OF THE FOLLOWING:
 - (i) FIELD EVIDENCE
 - (ii) INFORMATION TAKEN FROM FILES BELONGING TO TRAINOR SURVEYS (1974) LTD.
 - (iii) REGISTERED PLANS AND DOCUMENTS AS NOTED ON THIS PLAN.
 3. THE INFORMATION EXPRESSED ON THIS PLAN IS ISSUED TO and MAY BE RELIED UPON SOLELY BY THE PROSPECTIVE OWNER FOR WHOM THIS PLAN IS INTENDED. THE SURVEYOR HAS NO LIABILITY FOR ANY ERRORS AND LOCAL ADJUSTMENTS RELIANT ON SUCH INFORMATION BY THIRD PARTIES SHALL BE AT THEIR OWN RISK, and WE ASSUME NO LIABILITY FOR ANY SUCH INFORMATION.
 4. NO DENIAL SERVICE NEW BRUNSWICK, LINTERS
 5. SMALL MEASUREMENTS WERE OBTAINED FROM THE SINKING.
 6. OFFSET DISTANCES WERE CALCULATED TO THE SINKING.
 7. P.M. NUMBERS WERE OBTAINED FROM S.M.S. ONLINE RESOURCE "TRAKET".
 8. LOT 07-1 AND PID 40091720 HAVE THE BENEFIT OF ANY RESidual RIGHTS BETWEEN THE ORDINARY WATER MARK AND THE MIDDLE OF THE SOUTHWEST MERRIMACH RIVER.
 9. POINT SCALE FACTOR IS 0.999913.
- TRAINOR SURVEYS (1974) LTD., 2010
REPRODUCTION OF THIS PLAN WITHOUT THE WRITTEN PERMISSION OF TRAINOR SURVEYS (1974) LTD. OR THE PLAN WHEREON THE SURVEY WAS CONDUCTED IS PROHIBITED.

LEGEND

- LANDS DEALT WITH BY THIS PLAN BOUNDARY
 - STANDARD SURVEYER PLACED
 - UTILITY MARKER FOUND
 - OVERHEAD UTILITY LINES
 - UTILITY POLE AND ANCHOR
 - WELL
 - COORDINATE VALUE
 - BUILDING
 - FENCE
 - SQUARE METRES
 - HECTARES
 - N.C.R.O. NORTH BRUNSWICK COUNTY REGISTRY OFFICE
 - CIVIC NUMBER
- GPS GLOBAL POSITIONING SYSTEM
HPN HIGH PRECISION NETWORK
REG. REGISTERED
— OVERHEAD UTILITY LINES
— UTILITY POLE AND ANCHOR
WELL

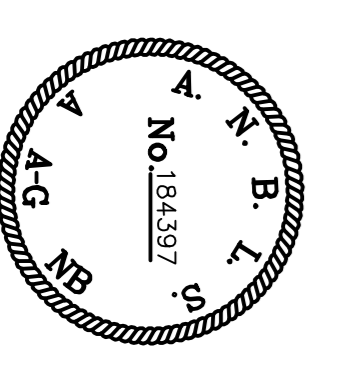

THE CO-ORDINATE VALUES LISTED ARE NAD83(GRS) ADJUSTED AND WERE DERIVED FROM A1577 VALUES USING THE SIB GRID SHIFT FILE.

Point	Easting	Northing	Description
8	2511305.752	7499530.941	SM FD
201	2511278.895	7499488.020	CALCULATED CORNER
202	2511288.311	7499480.134	CALCULATED CORNER
245	2511305.505	7499476.194	SM FD
246	2511292.357	7499472.260	SM FD
247	2511295.543	7499465.982	SM FD
248	2511292.357	7499465.982	CALCULATED CORNER
268	2511417.09	7499501.359	CALCULATED CORNER
271	251116.743	7499439.807	RIGHT-OF-WAY CORNER
301	2511290.500	7499607.883	SM FD
418	2511272.079	7499481.287	SM FD
430	2511356.501	7499477.248	SM FD
433	2511291.407	7499429.842	SM FD

NOTE: THE SURVEYOR ASSUMES NO RESPONSIBILITY FOR THE ABSOLUTE POSITION OF THE COORDINATE VALUES.

COURSE TABLES

Course	Bearing	Distance
L1	084°25'10"	12.800
L2	067°54'30"	16.420
L3	067°54'30"	16.420
L4	067°54'30"	1.950
L5	099°35'10"	2.920

Curve	Radius	Length	Chord	Chord Bear.
C1	40.580	31.823	31.050	78028.30°
C2	37.600	20.212	19.970	69029.10°
C3	12.300	15.750	14.680	47°48'10"
C4	14.100	13.952	13.590	58°33'20"
C5	35.710	19.792	19.540	83°47'20"

- COMMON RIVER ACCESS
- COMMON ROAD ACCESS
- INDIVIDUAL EXISTING CAMP
- COMMON GREEN SPACE

Lot 07-01
PID 40498958
K W POND LIMITED
LAND TITLES REGISTRATION: 17835550
LAND TITLES FIRST NOTICE: 17817579
DEED 31104 BK 543 Pg 350
N.C.R.O. PLAN NO. 27123802
REG. 2004-03-22
UPLAND AREA = 3630m²

Lot 1
PID 40085193
DANIEL PETER CAIN
N.C.R.O. PLAN NO. 1956
REG. 1980-07-25
FIRST NOTICE: 14151440
DEED 18099827
REG. 2004-03-22

FUTURE DEVELOPMENT
LOT 10-3
AREA = 4509m²

PID 40091720
K W POND LIMITED
LAND TITLES REGISTRATION: 17835550
LAND TITLES FIRST NOTICE: 17817579
DEED 31104 BK 543 Pg 350
N.C.R.O. PLAN NO. 27123802
REG. 2004-03-22
UPLAND AREA = 25560m²

FUTURE DEVELOPMENT
LOT 10-2
AREA = 4430m²

FUTURE DEVELOPMENT
LOT 10-1
AREA = 4636m²

PID 40345514
643589 NB LTD.
LAND TITLES DOCUMENT: 27554628
SEE ALSO REGISTERED PLAN, TO BE REGISTERED AND PREPARED BY TRAINOR SURVEYS LTD. WITH PLAN REFERENCE: 09310

PID 40345514
QUIT CLAIM DEED 1405 902
DEED 260 BK 285 Pg 289

PID 40091779
KEITH W. POND
QUIT CLAIM DEED 11012250
DEED 46547 BK 666 Pg 289

PID 40091761
CNBT MANAGEMENT LTD.
DEED 20442752
REG. 2009-06-14

NEW BRUNSWICK GRID NORTH
TRAINOR SURVEYS (1974) LTD.

SOUTHWEST MERRIMACH RIVER
APPROXIMATE MIDDLE THRESHOLD OF THE SOUTHWEST MERRIMACH RIVER

